

# Medical Cabinets

1-800-663-3412  
[www.afcindustries.com](http://www.afcindustries.com)

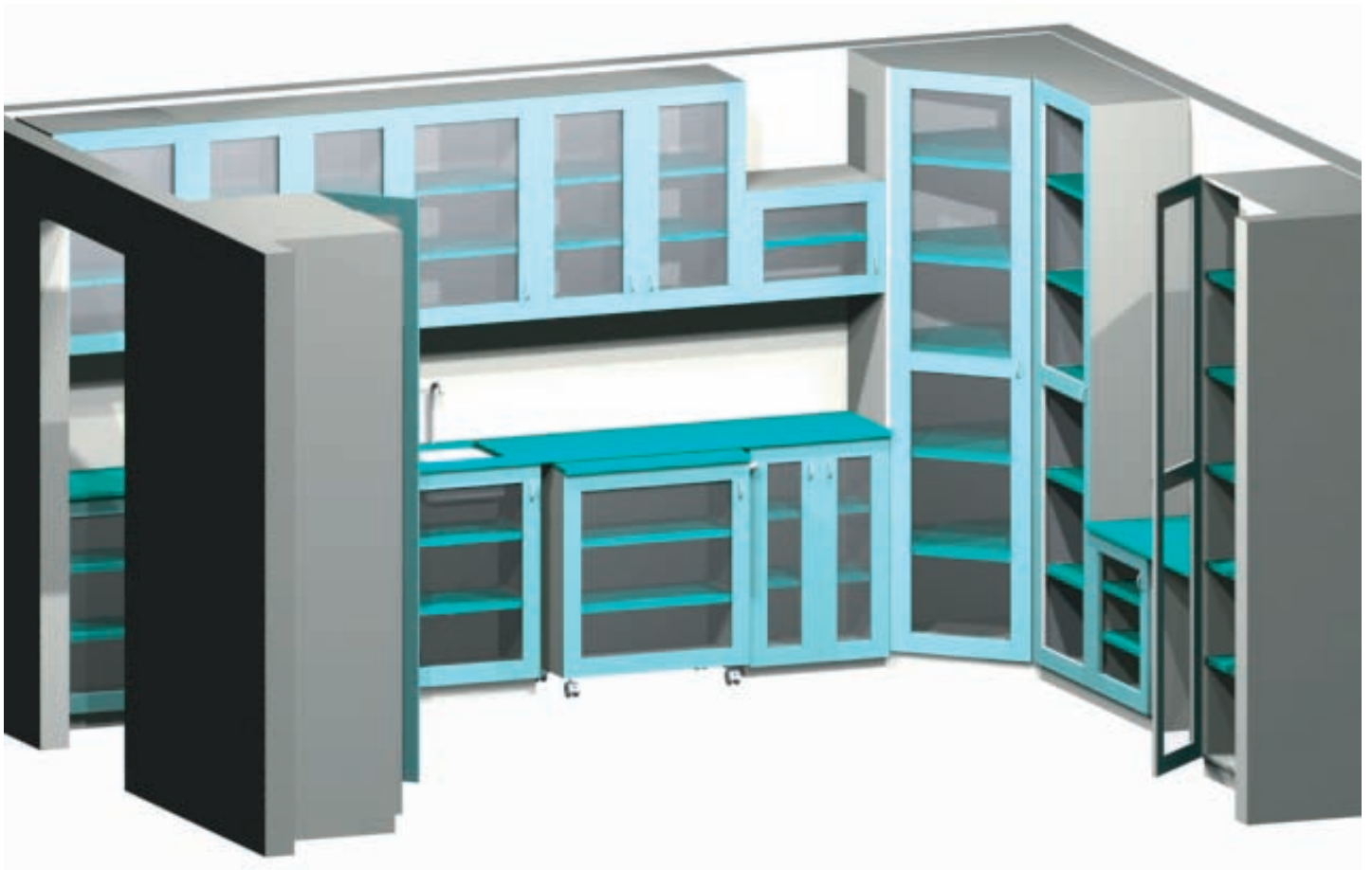

1_	<i>Floor Cabinets</i>
3_	<i>Countertop Profiles</i>
4_	<i>Wall Cabinets</i>
6_	<i>Storage Cabinets</i>
8_	<i>Mobile Carts</i>
9_	<i>Sample Room Layouts</i>
11_	<i>Colors</i>

# Floor Cabinets

## Sizes:

Width: 24" \_ with single door  
36" \_ with double door

Depth: 18"  
24"

Height: 30" \_ Seated Height  
36" \_ Counter Height  
39" \_ Standing Height

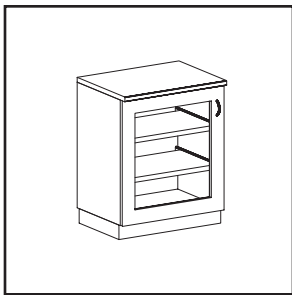
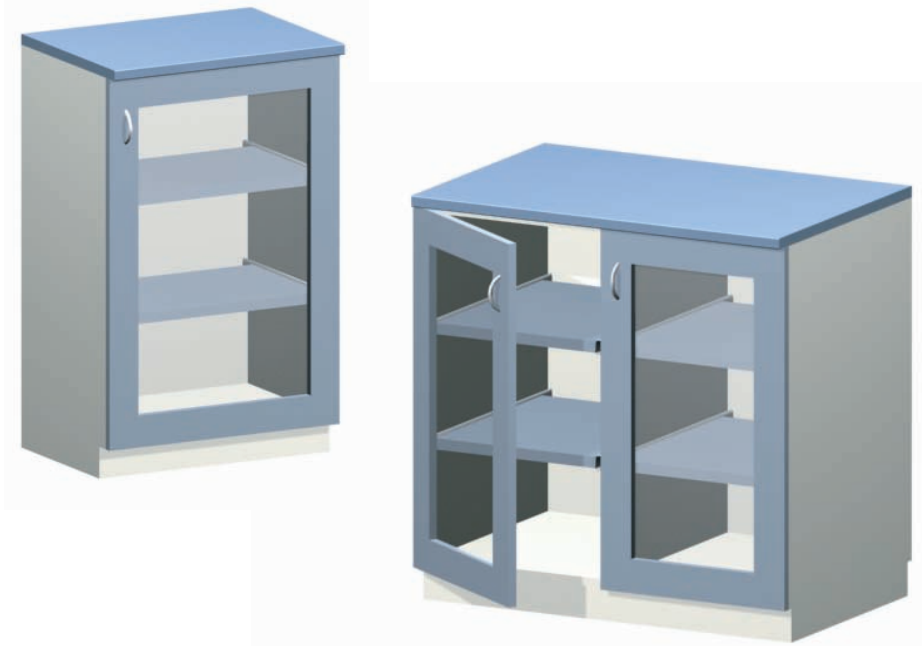

FC 24"W x 18"D x 30"H

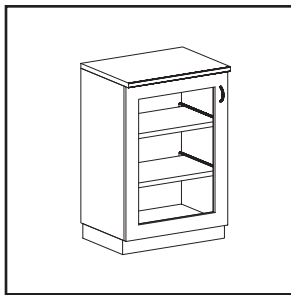

FC 24"W x 18"D x 36"H

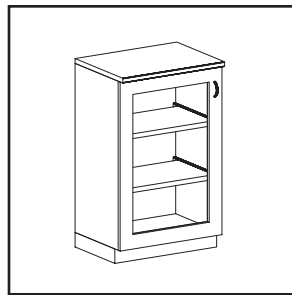

FC 24"W x 18"D x 39"H

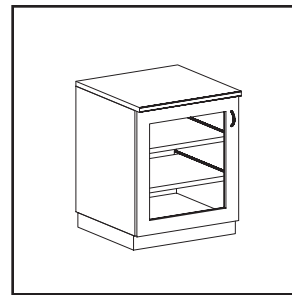

FC 24"W x 24"D x 30"H

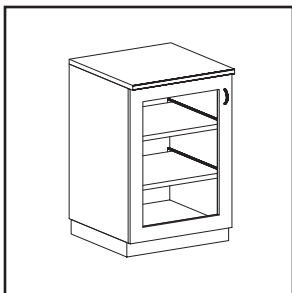

FC 24"W x 24"D x 36"H

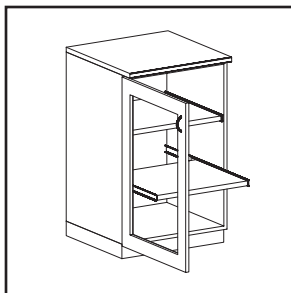

FC 24"W x 24"D x 39"H

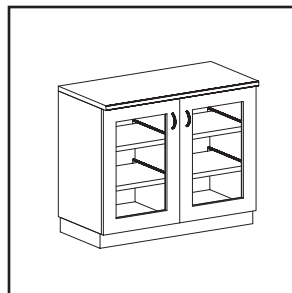

FC 36"W x 18"D x 30"H

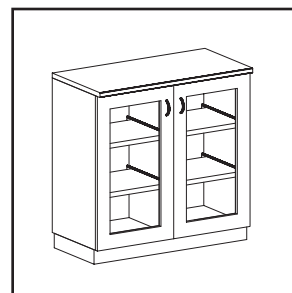

FC 36"W x 18"D x 36"H

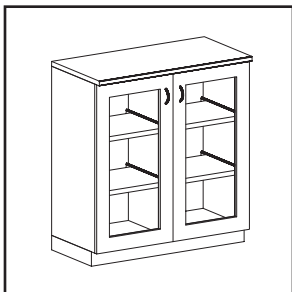

FC 36"W x 18"D x 39"H

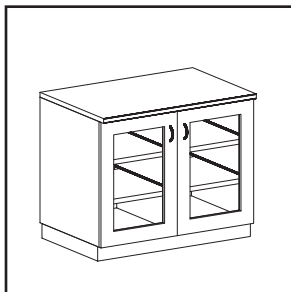

FC 36"W x 24"D x 30"H

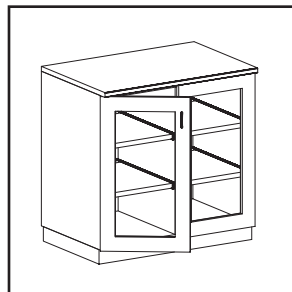

FC 36"W x 24"D x 36"H

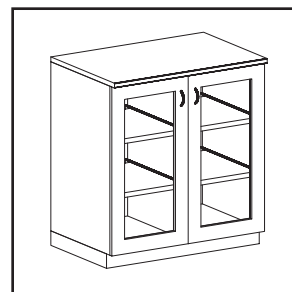

FC 36"W x 24"D x 39"H

# Floor Cabinets

1-800-663-3412  
[www.afcindustries.com](http://www.afcindustries.com)

## **Shelves:**

*The Floor Cabinets come with Rolling Shelves.  
All shelves are height adjustable.*

## **Options:**

*Corner Floor Cabinet*



*Floor Cabinet with Sink*

*Two Floor Cabinets connected with a Counter Top to create a desk*

# Countertop Profiles

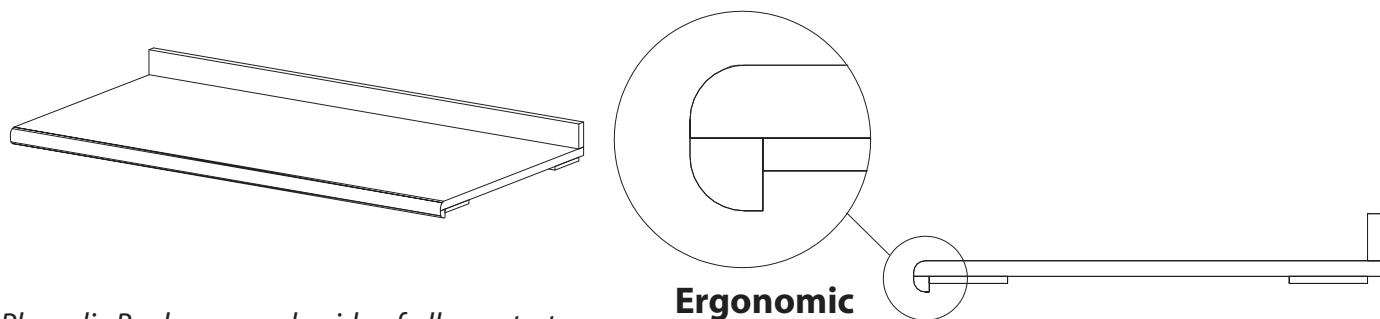
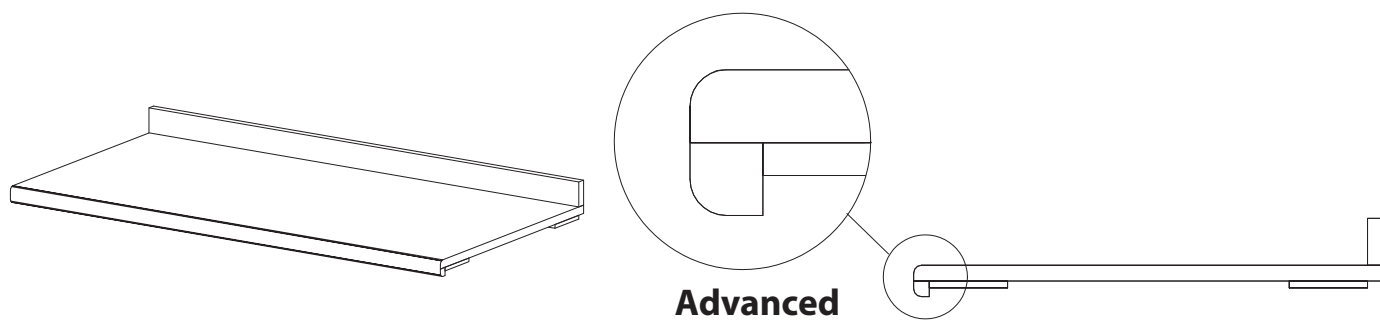
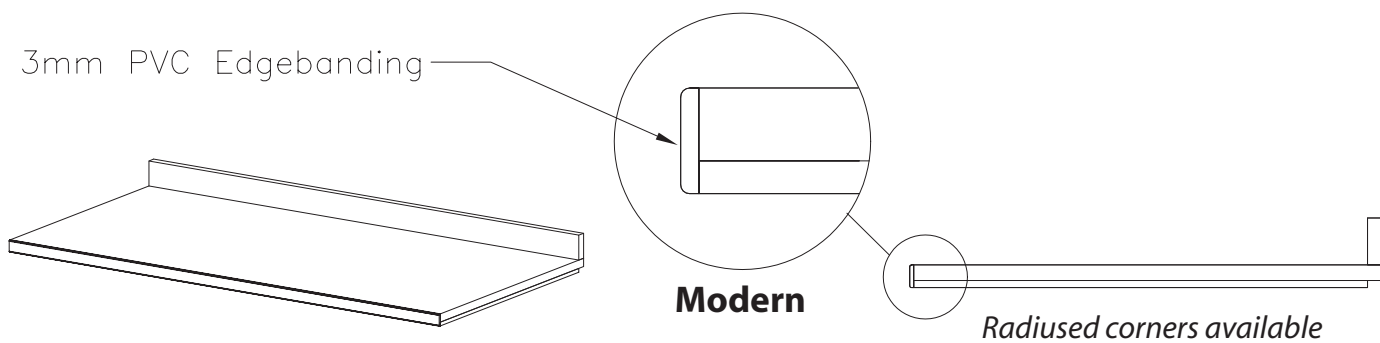
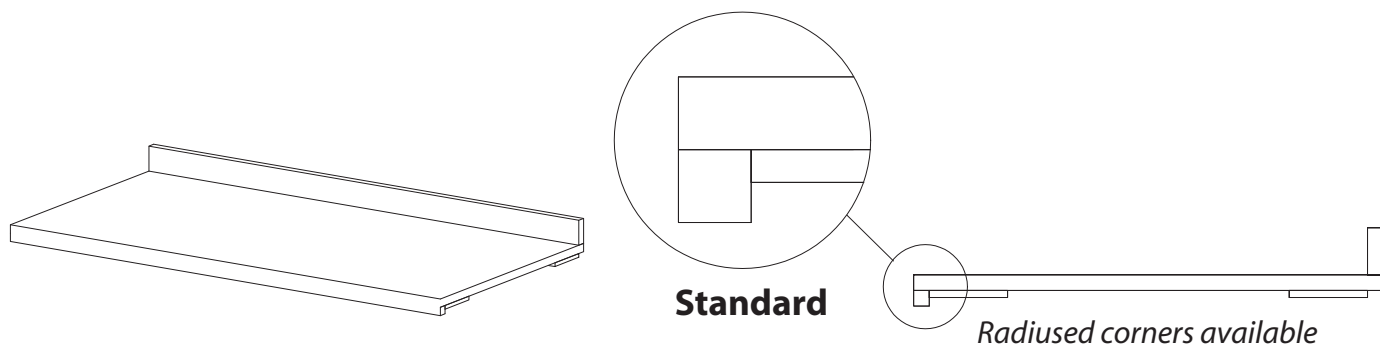

*Phenolic Backer on underside of all countertops*

# Wall Cabinets



**Sizes:**

Width: 24" \_ with single door  
36" \_ with double door

Depth: 16"

Height: 18"  
24"  
36"

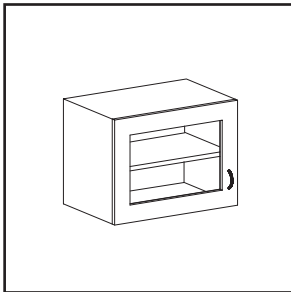

WC 24"W x 16"D x 18"H

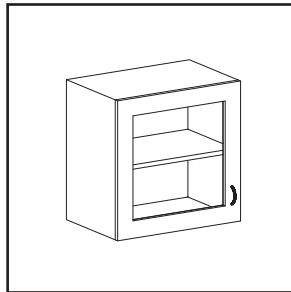

WC 24"W x 16"D x 24"H

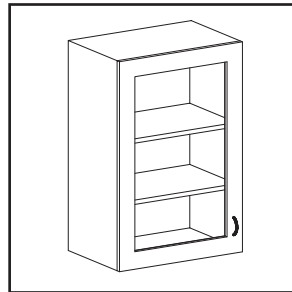

WC 24"W x 16"D x 36"H

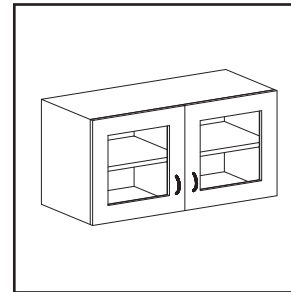

WC 36"W x 16"D x 18"H

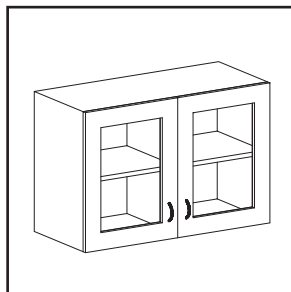

WC 36"W x 16"D x 24"H

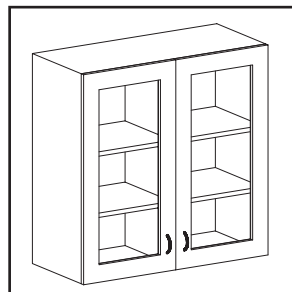

WC 36"W x 16"D x 36"H

# Wall Cabinets

**Shelves:**

The Wall Cabinets come with regular shelves.  
All shelves are height adjustable.

**Options:**

Corner Wall Cabinet



2-door Wall Cabinet

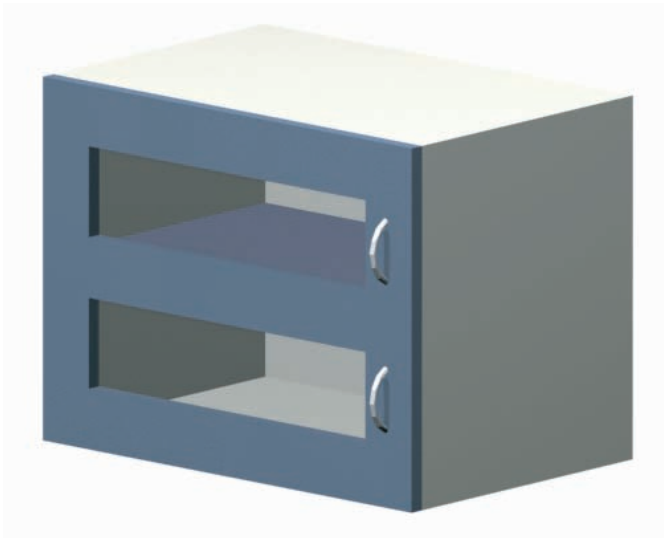

# Storage Cabinets

1-800-663-3412  
www.afcindustries.com

## Sizes:

Width: 24" \_ with single door  
36" \_ with double door

Depth: 18"  
24"

Height: 72"  
86"

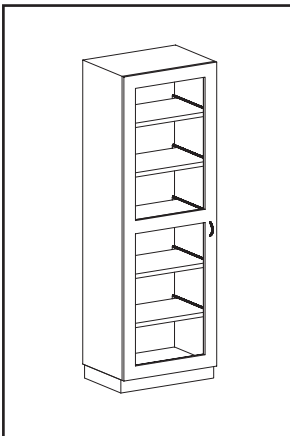

SC 24"W x 18"D x 72"H

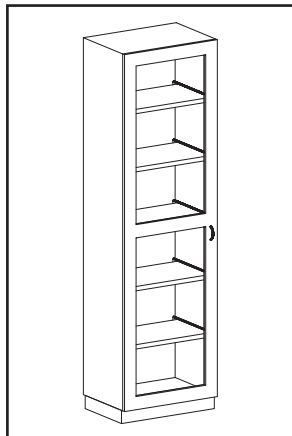

FC 24"W x 18"D x 86"H

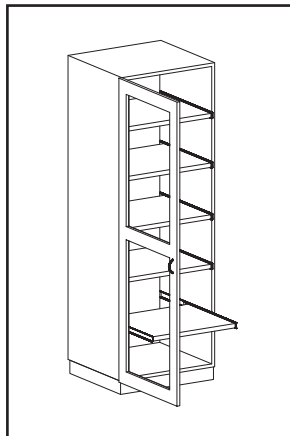

FC 24"W x 24"D x 72"H

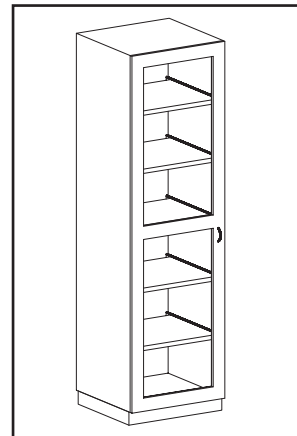

FC 24"W x 24"D x 86"H

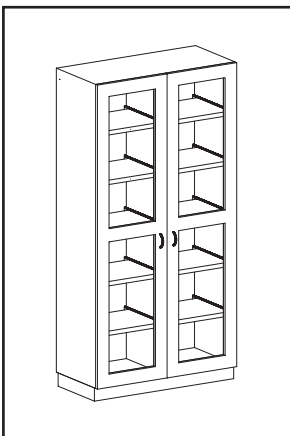

FC 36"W x 18"D x 72"H

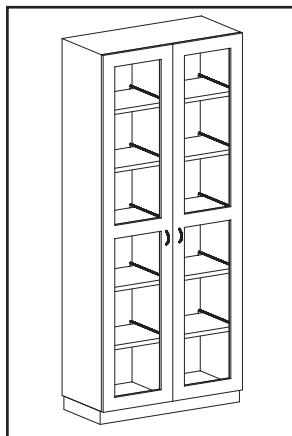

FC 36"W x 18"D x 86"H

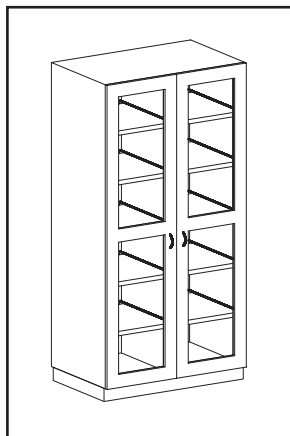

FC 36"W x 24"D x 72"H

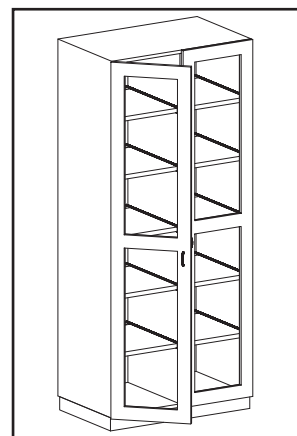

FC 36"W x 24"D x 86"H



# Storage Cabinets

1-800-663-3412  
[www.afcindustries.com](http://www.afcindustries.com)

## **Shelves:**

*The Storage Cabinets come with Rolling Shelves.  
All shelves are height adjustable.*

## **Options:**

*Corner Storage Cabinet*



*Combined Doors*

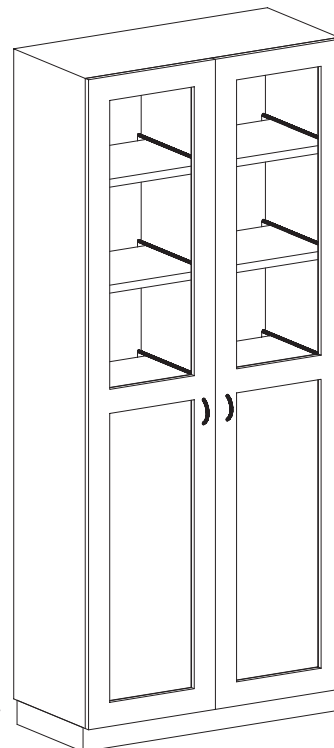

# Mobile Cart

1-800-663-3412  
[www.afcindustries.com](http://www.afcindustries.com)

## **Size:**

*Width: 20" - 32" \_ with single door*

*Depth: 18"*

*Height: 28" - 38" \_ Able to roll under counter top*

## **Shelves:**

*The Mobile Carts come with Rolling Shelves.*

*All shelves are height adjustable.*



# Room Layouts

1-800-663-3412  
www.afcindustries.com

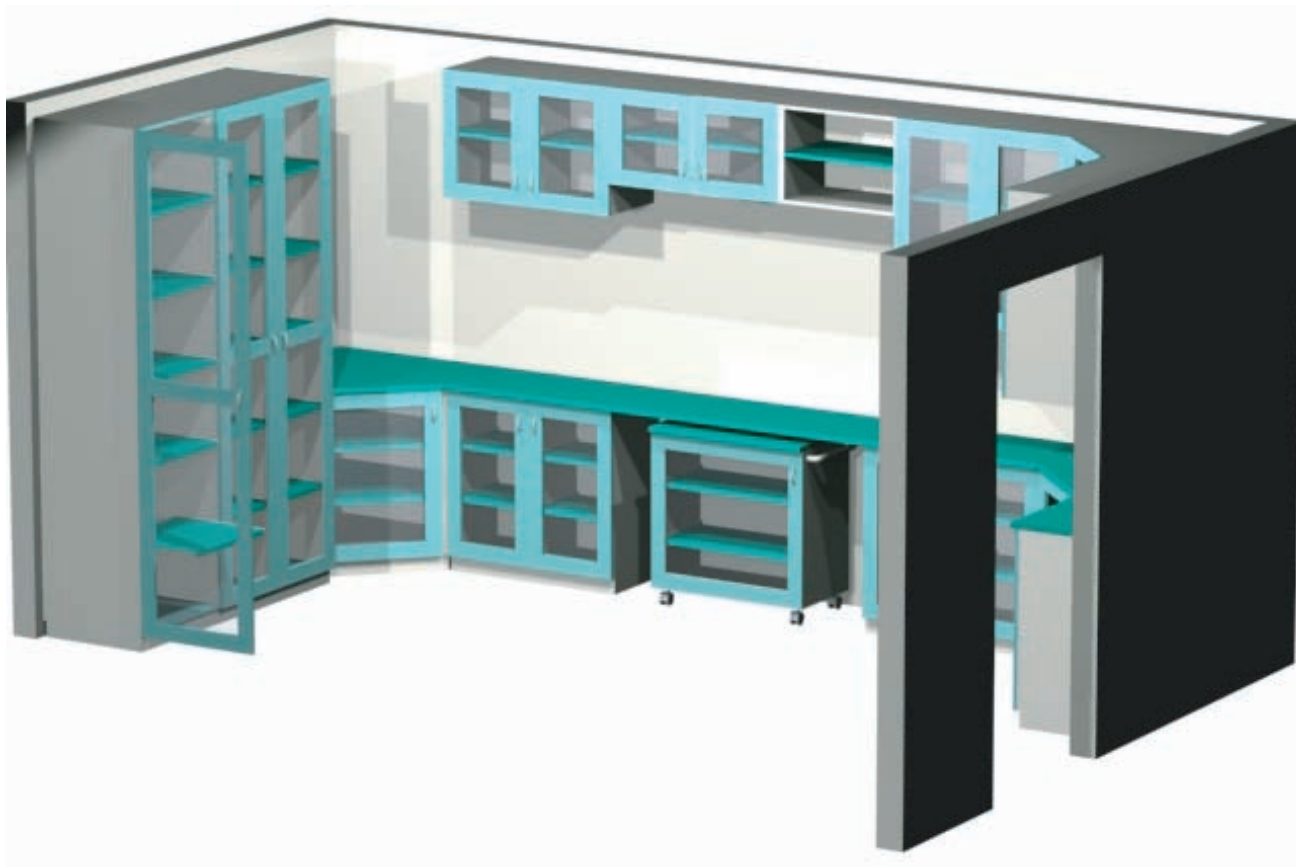

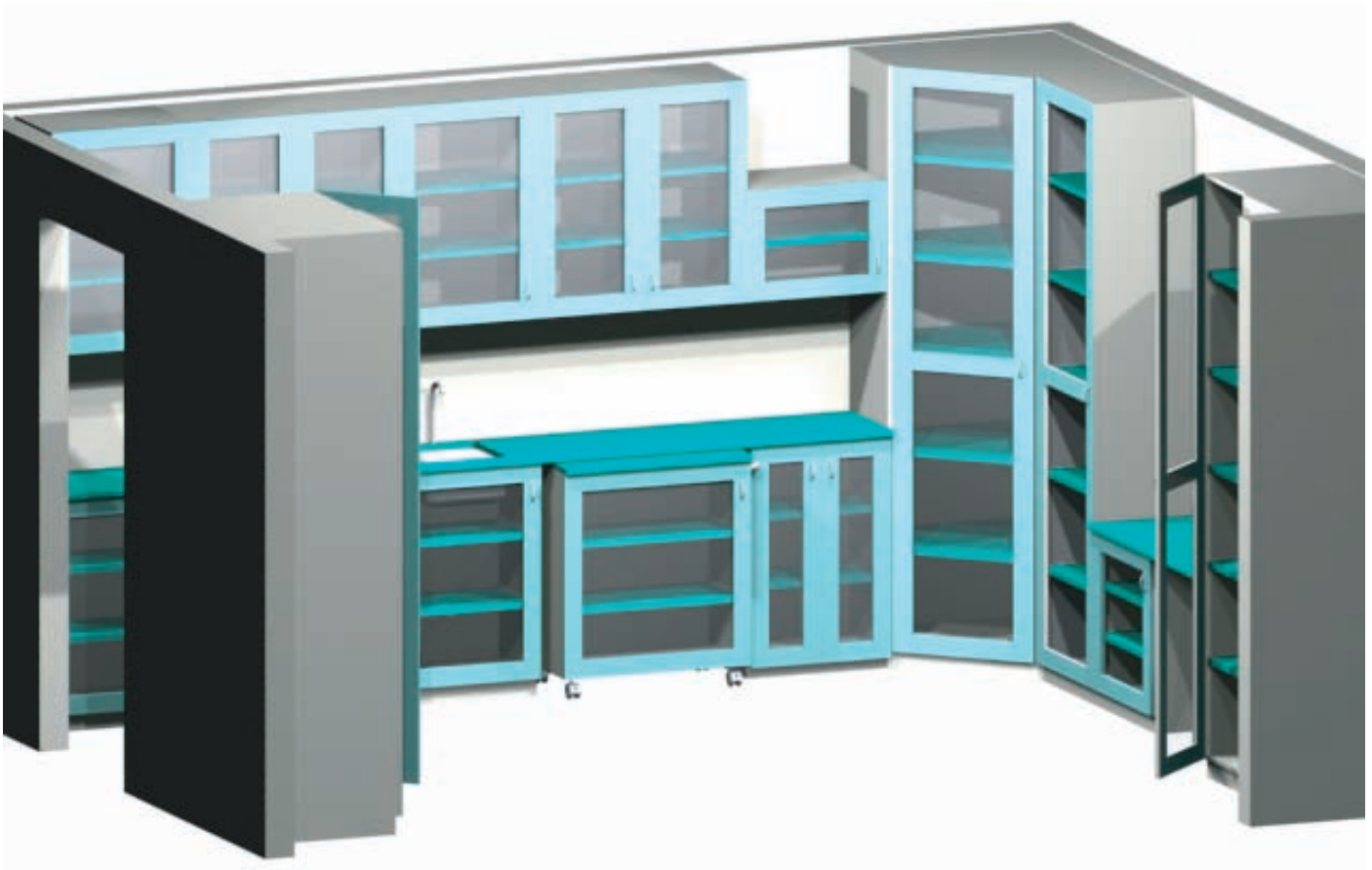

# Colors

## **Standard Colors:**

*For any other color, please consult our engineering department.*



Blue Rio



Blue Mirage



Rose Mirage



Emerald



Black

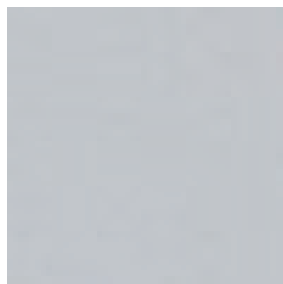

Light Gray

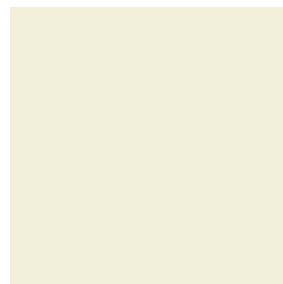

Putty

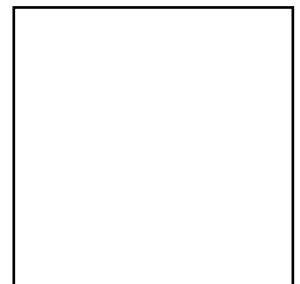

White



Cherry



Tan Cherry



Guam Pear

## **Countertops:**

*Countertops also come in Solid Surfacing Material. Consult our engineering department for available colors.*